

F A N S



Koger Air Industrial Material and Air Handling Fans

Koger Air Industrial Material and Air Handling Fans range from sizes 11" to 41" and are fabricated from $\frac{1}{4}$ " or heavier plate to handle system capacities from 660 to 60,000 cfm of air. Each fan is totally interchangeable to a clockwise or counterclockwise discharge. In addition, the fans are precision balanced in two planes, side-to-side and end-to-end, to minimize noise and vibration. Standard size fans normally ship same day of order. Special-order fans made of Abrasion Resistant, Stainless and Heat Resistant Steels are normally shipped within two weeks.

Fan Wheel

- Radial open and self-cleaning
- Six-bladed wheel is a solid weld design with single spokes in fan sizes 11 and 13, and dual spokes for fan sizes 15 through 41

Fan Bearings

- Self-aligning, double row tapered roller bearings
- One-piece cast iron bearing housing handles high radial and thrust loads

Shafting

- Precision machined from ground, polished and straightened shafting

Scroll Housing

- 100% welded, heavy-duty scroll housing
- Interchangeable to a clockwise or counterclockwise discharge

Pedestal

- Heavy-duty pedestal supports, bearings, shaft and wheel
- Bearing mounts allow easy removal of bearings while giving maximum support to moving parts
- Removable pedestal allows assembly in desired rotation



Inlets and Outlets

- Fan inlet is proportional to the fan outlet
- Standard fan inlet is a straight collar design for removal of fan sleeve connection
- Standard fan outlet is a flanged construction to provide maximum strength and simplify outside bolt connection of ductwork

Custom Options

- Shaft seal
- Custom materials for wheel and housing include Abrasion Resistant, Stainless and Heat Resistant Steels
- Unitary Steel Support
- Flexible Inlet and Outlet Connections
- Flanged Inlet
- Outlet Transition
- Access Door
- Drain
- Arrangement 9
- Backplate Wheels

AMCA Licensed

Koger Air Corporation certifies that the Koger Industrial Material and Air Handling Fans shown on pages 12 to 23 are licensed to bear the AMCA seal. The ratings shown are based on tests and procedures performed in accordance with AMCA Publication 211 and comply with the requirements of the AMCA Certified Ratings Program.



Inlet Size - 21" Dia. Outside
 Outlet Size - 17¹/₁₆" x 20¹/₄" Outside
 Wheel Diameter - 36¹/₂"
 Tip Speed = 9.56 x RPM

Inlet Area - 2.40 Sq. Ft. Outside
 Outlet Area - 2.35 Sq. Ft. Inside
 Wheel Circumference - 9.56 Ft.
 Max Safe Fan Speed - 1570 RPM

Power Rating (BHP) does not include transmission losses. Performance Ratings do not include the effects of appurtenances (accessories). All capacities based on standard air (density .075 #/cu. ft. 70°F. 29.92" Hg. Bar.). Performances shown in the color zone are those operating at maximum static efficiency. Performances shown above colored line are those operating within optimum operation range. Performance certified is for installation type D - ducted inlet, ducted outlet.

SP*.>>		1		2		3		4		5		6		7		8		9	
OV*	CFM*	RPM	BHP	RPM	BHP	RPM	BHP	RPM	BHP	RPM	BHP	RPM	BHP	RPM	BHP	RPM	BHP	RPM	BHP
1000	2380	379	0.64	520	1.30														
1200	2856	392	0.79	526	1.53	636	2.35												
1400	3332	406	0.97	535	1.78	641	2.68	735	3.65	817	4.64								
1600	3808	423	1.19	547	2.07	650	3.05	740	4.09	822	5.18	897	6.32	965	7.47				
1800	4284	441	1.343	561	2.41	660	3.45	748	4.57	828	5.75	902	6.98	970	8.22	1034	9.52		
2000	4760	461	1.72	576	2.78	673	3.91	758	5.10	836	6.36	907	7.64	976	9.02	1039	10.38	1099	11.80
2200	5236	482	2.06	593	3.21	687	4.42	770	5.69	846	7.02	916	8.38	981	9.79	1045	11.29	1104	12.77
2400	5712	505	2.45	610	3.68	702	4.97	784	6.34	857	7.72	926	9.17	991	10.69	1051	12.20	1110	13.80
2600	6188	528	2.89	630	4.22	718	5.58	798	7.02	870	8.49	936	9.99	1001	11.61	1061	13.23	1118	14.89
2800	6664	551	3.38	650	4.81	735	6.26	813	7.77	884	9.33	950	10.94	1011	12.56	1071	14.29	1127	16.02
3000	7140	576	3.96	670	5.44	753	7.00	829	8.59	899	10.24	964	11.93	1025	13.67	1081	15.38	1137	17.21
3200	7616	601	4.60	692	6.16	773	7.82	846	9.49	915	11.23	978	12.96	1039	14.82	1095	16.64	1148	18.49
3400	8092	626	5.30	715	6.97	793	8.70	863	10.44	931	12.27	993	14.09	1053	16.02	1109	17.96	1162	19.91
3600	8568	652	6.09	738	7.84	813	9.63	883	11.51	948	13.40	1010	15.35	1067	17.26	1123	19.32	1176	21.39
3800	9044	678	6.95	761	8.77	834	10.65	903	12.64	965	14.59	1026	16.62	1083	18.66	1137	20.72	1190	22.91
4000	9520	705	7.92	785	9.81	857	11.81	923	13.84	984	15.88	1043	18.00	1100	20.17	1153	22.30	1204	24.49
4200	9996	731	8.94	809	10.92	879	13.00	943	15.10	1004	17.28	1060	19.43	1116	21.68	1169	23.95	1219	26.20
4400	10472	758	10.07	834	12.16	902	14.31	965	16.52	1024	18.75	1080	21.03	1133	23.32	1186	25.71	1236	28.09
4600	10948	786	11.29	859	13.49	926	15.74	987	18.01	1045	20.35	1100	22.72	1152	25.11	1203	27.55	1252	29.99
4800	11424	815	12.63	885	14.96	949	17.21	1010	19.64	1065	21.96	1120	24.48	1171	26.95	1219	29.39	1269	32.03
5000	11900	843	14.03	910	16.46	973	18.81	1033	21.35	1087	23.77	1141	26.39	1191	28.93	1239	31.51	1286	34.14
5200	12376	872	15.58	936	18.12	997	20.52	1056	23.16	1110	25.73	1161	28.31	1211	30.99	1259	33.71	1304	36.37
5400	12852	901	17.24	963	19.94	1023	22.47	1079	25.05	1133	27.79	1183	30.46	1232	33.22	1279	36.00	1324	38.80
5600	13328	930	19.01	989	21.81	1048	24.45	1103	27.12	1156	29.95	1205	32.69	1252	35.46	1299	38.38	1344	41.32
5800	13804	959	20.89	1015	23.78	1073	26.54	1127	29.28	1179	32.20	1228	35.10	1274	37.95	1320	40.95	1364	43.93
6000	14280	989	22.97	1042	25.94	1099	28.82	1151	31.57	1202	34.56	1251	37.62	1296	40.53	1340	43.51	1384	46.65
6200	14756	1018	25.10	1069	28.22	1125	31.22	1176	34.06	1226	37.11	1274	40.25	1319	43.32	1362	46.37	1405	49.56
6400	15232	1047	27.36	1097	30.63	1151	33.74	1202	36.77	1250	39.77	1297	42.99	1342	46.21	1384	49.32	1425	52.47
6600	15708	1077	29.83	1125	33.14	1177	36.39	1227	39.50	1274	42.56	1320	45.84	1364	49.12	1407	52.48	1447	55.69

SIZE
21

SP*.>>		10		11		12		13		14		15		16		17		18	
OV*	CFM*	RPM	BHP	RPM	BHP	RPM	BHP	RPM	BHP	RPM	BHP	RPM	BHP	RPM	BHP	RPM	BHP	RPM	BHP
2000	4760	1156	13.24	1209	14.67														
2200	5236	1161	14.32	1215	15.88	1266	17.44	1316	19.07										
2400	5712	1166	15.41	1220	17.08	1272	18.78	1321	20.46	1368	22.16	1414	23.90						
2600	6188	1172	16.57	1226	18.33	1277	20.09	1326	21.87	1374	23.72	1419	25.51	1464	27.41	1506	29.27	1548	31.13
2800	6664	1181	17.80	1232	19.59	1282	21.42	1332	23.35	1379	25.25	1425	27.20	1469	29.13	1511	31.13	1554	33.12
3000	7140	1191	19.11	1242	21.00	1291	22.92	1337	24.80	1384	26.80	1430	28.85	1474	30.88	1517	32.98	1559	35.07
3200	7616	1201	20.45	1252	22.45	1300	24.41	1347	26.45	1392	28.49	1436	30.58	1480	32.72	1522	34.88	1564	37.04
3400	8092	1212	21.86	1261	23.87	1310	26.00	1357	28.15	1402	30.29	1445	32.42	1487	34.59	1528	36.85	1570	39.11
3600	8568	1226	23.45	1273	25.48	1320	27.63	1367	29.89	1411	32.07	1455	34.37	1497	36.65	1537	38.93	1577	41.22
3800	9044	1240	25.09	1287	27.24	1333	29.45	1376	31.60	1421	33.95	1465	36.36	1507	38.74	1547	41.13	1587	43.52
4000	9520	1254	26.79	1301	29.05	1347	31.38	1390	33.63	1432	35.93	1474	38.32	1516	40.80	1556	43.30	1596	45.79
4200	9996	1268	28.54	1315	30.92	1361	33.37	1404	35.73	1446	38.14	1487	40.59	1526	42.99	1566	45.59	1606	48.19
4400	10472	1283	30.43	1329	32.84	1375	35.41	1418	37.89	1460	40.41	1500	42.90	1540	45.49	1578	48.06	1616	50.63
4600	10948	1300	32.52	1345	34.98	1389	37.51	1432	40.11	1474	42.75	1514	45.35	1554	48.06	1591	50.66	1628	53.26
4800	11424	1316	34.62	1361	37.20	1404	39.77	1446	42.39	1488	45.15	1528	47.86	1568	50.70	1605	53.41	1642	56.12
5000	11900	1333	36.87	1377	39.50	1420	42.19	1462	44.93	1502	47.62	1543	50.54	1582	53.40	1619	56.22	1656	59.05
5200	12376	1349	39.10	1394	41.95	1437	44.77	1478	47.55	1518	50.36	1557	53.20	1596	56.17	1633	59.11	1670	62.06
5400	12852	1367	41.58	1411	44.49	1453	47.34	1494	50.24	1534	53.18	1572	56.04	1610	59.01	1647	62.07	1684	65.13
5600	13328	1386	44.14	1428	47.10	1470	50.09	1511	53.13	1551	56.19	1589	59.18	1626	62.17	1662	65.28	1699	68.40
5800	13804	1406	46.90	1447	49.91	1487	52.93	1528	56.03	1567	59.18	1605	62.29	1642	65.41	1677	68.52	1713	71.63
6000	14280	1426	49.75	1467	52.91	1505	55.89	1545	59.15	1584	62.38	1622	65.61	1659	68.86	1694	72.04	1729	75.21
6200	14756	1446	42.70	1487	56.00	1525	59.11	1562	62.25	1601	65.66	1638	68.90	1675	72.28	1710	75.65	1746	79.02
6400	15232	1467	55.86	1507	59.20	1545	62.45	1581	65.73	1618	69.00	1655	72.41	1692	75.92	1727	79.35	1762	82.78
6600	15708	1487	59.02	1527	62.50	1565	65.89	1602	69.31	1638	72.72	1672	76.00	1709	79.66	1744	83.22	1779	86.79

*SP - Static Pressure Inches H₂O *OV - Outlet Velocity (Feet Per Minute) *CFM - Cubic Feet Per Minute

Inlet Size - 23" Dia. Outside
 Outlet Size - 19½" x 22¼" Outside
 Wheel Diameter - 40"
 Tip Speed = 10.47 x RPM

Inlet Area - 2.88 Sq. Ft. Outside
 Outlet Area - 2.85 Sq. Ft. Inside
 Wheel Circumference - 10.47 Ft.
 Max Safe Fan Speed - 1435 RPM

Power Rating (BHP) does not include transmission losses. Performance Ratings do not include the effects of appurtenances (accessories). All capacities based on standard air (density .075 #/cu. ft. 70°F. 29.92" Hg. Bar.). Performances shown in the color zone are those operating at maximum static efficiency. Performances shown above colored line are those operating within optimum operation range. Performance certified is for installation type D - ducted inlet, ducted outlet.

SIZE
 23

SP*.>>		1		2		3		4		5		6		7		8		9	
OV*	CFM*	RPM	BHP	RPM	BHP	RPM	BHP	RPM	BHP	RPM	BHP	RPM	BHP	RPM	BHP	RPM	BHP	RPM	BHP
1000	2880	346	0.77	474	1.57														
1200	3456	358	0.96	480	1.85	580	2.83	666	3.88										
1400	4032	372	1.18	489	2.16	585	3.23	671	4.41	746	5.62								
1600	4608	387	1.44	500	2.52	594	3.70	675	4.93	751	6.28	818	7.62	881	9.04				
1800	5184	404	1.75	513	2.92	603	4.18	684	5.55	755	6.93	823	8.42	886	9.96	944	11.51	998	13.07
2000	5760	422	2.10	527	3.38	615	4.74	693	6.19	764	7.71	828	9.24	891	10.90	949	12.57	1003	14.25
2200	6336	442	2.52	542	3.90	628	5.36	704	6.90	773	8.50	837	10.16	896	11.85	954	13.65	1008	15.45
2400	6912	463	3.00	558	4.47	642	6.04	716	7.67	783	9.35	846	11.11	905	12.93	960	14.77	1013	16.67
2600	7488	484	3.53	576	5.12	657	6.79	729	8.50	796	10.33	856	12.13	914	14.04	969	16.01	1021	18.02
2800	8064	506	4.15	595	5.85	672	7.60	743	9.42	808	11.11	868	13.25	924	15.23	978	17.29	1030	19.42
3000	8640	528	4.83	614	6.64	689	8.51	758	10.43	822	12.42	881	14.46	936	16.53	988	18.65	1039	20.87
3200	9216	551	5.61	634	7.52	707	9.49	774	11.54	836	13.60	894	15.73	949	17.94	1001	20.19	1049	22.40
3400	9792	575	6.50	655	8.50	726	10.59	790	12.70	852	14.93	908	17.10	962	19.40	1013	21.73	1062	24.14
3600	10368	598	7.44	676	9.55	745	11.75	808	13.99	867	16.28	923	18.60	976	20.98	1026	23.39	1075	25.94
3800	10944	622	8.50	698	10.73	764	12.98	826	15.35	883	17.74	939	20.23	991	22.70	1040	25.19	1087	27.73
4000	11520	647	9.69	719	11.95	785	14.39	845	16.84	901	19.34	954	21.87	1006	24.50	1054	27.06	1101	29.74
4200	12096	671	10.94	742	13.36	806	15.89	864	18.42	919	21.02	970	23.62	1021	26.36	1069	29.08	1115	31.83
4400	12672	696	12.34	765	14.88	827	17.48	884	20.14	938	22.86	989	25.63	1037	28.39	1085	31.26	1130	34.09
4600	13248	722	13.84	788	16.50	848	19.16	904	21.94	957	24.79	1007	27.65	1054	30.52	1100	33.44	1145	36.42
4800	13824	748	15.45	811	18.24	870	21.01	925	23.92	976	26.81	1026	29.86	1072	32.80	1116	35.78	1161	38.94
5000	14400	775	17.24	835	20.15	892	22.97	946	26.00	996	29.00	1044	32.07	1091	35.28	1134	38.33	1176	41.45
5200	14976	801	19.10	859	22.19	915	25.14	968	28.28	1017	31.38	1063	34.47	1109	37.76	1152	40.97	1194	44.30
5400	15552	828	21.16	883	24.35	938	27.44	989	30.58	1038	33.88	1083	37.06	1128	40.44	1171	43.83	1212	47.22
5600	16128	854	23.28	908	26.73	961	29.87	1011	33.09	1059	36.50	1104	39.86	1147	43.24	1190	46.81	1230	50.25
5800	16704	881	25.62	932	29.16	985	32.53	1033	35.73	1080	39.24	1125	42.79	1167	46.26	1208	49.78	1249	53.51
6000	17280	908	28.11	957	31.82	1008	35.23	1056	38.64	1102	42.21	1146	45.85	1187	49.38	1227	52.99	1267	56.77
6200	17856	935	30.76	981	34.53	1032	38.18	1079	41.69	1124	45.32	1167	49.04	1208	52.76	1247	56.43	1286	60.28
6400	18432	962	33.56	1007	37.48	1056	41.27	1102	44.89	1146	48.57	1189	52.50	1229	56.27	1268	60.14	1305	63.91
6600	19008	989	36.53	1033	40.58	1080	44.53	1125	48.25	1168	51.98	1210	55.96	1250	59.93	1289	63.99	1325	67.80

SP*.>>		10		11		12		13		14		15		16		17		18	
OV*	CFM*	RPM	BHP	RPM	BHP	RPM	BHP	RPM	BHP	RPM	BHP	RPM	BHP	RPM	BHP	RPM	BHP	RPM	BHP
2000	5760	1055	15.99	1104	17.75														
2200	6336	1060	17.32	1109	19.19	1156	21.10	1201	23.03										
2400	6912	1065	18.67	1114	20.66	1161	22.69	1206	24.74	1249	26.79	1291	28.90	1331	30.99				
2600	7488	1070	20.03	1119	22.15	1166	24.30	1211	26.48	1254	28.65	1296	30.88	1336	33.09	1375	35.35	1413	37.61
2800	8064	1079	21.57	1125	23.69	1171	25.94	1216	28.24	1259	30.53	1301	32.89	1341	35.21	1380	37.59	1418	39.98
3000	8640	1088	23.14	1134	25.39	1179	27.73	1221	30.00	1264	32.44	1306	34.92	1346	37.37	1385	39.87	1423	42.37
3200	9216	1097	24.76	1143	27.13	1188	29.60	1230	32.00	1271	34.45	1311	36.97	1351	39.55	1390	42.18	1428	44.80
3400	9792	1107	26.46	1152	28.92	1197	31.52	1239	34.04	1280	36.62	1320	39.26	1358	41.86	1396	44.55	1433	47.25
3600	10368	1120	28.39	1164	30.94	1206	33.48	1248	36.13	1289	38.84	1329	41.61	1367	44.33	1403	47.09	1440	49.85
3800	10944	1133	30.40	1176	33.00	1218	35.68	1258	38.34	1298	41.11	1338	44.01	1376	46.85	1412	49.74	1449	52.62
4000	11520	1146	32.47	1189	35.21	1231	38.04	1270	40.74	1309	43.59	1347	46.46	1385	49.43	1421	52.44	1458	55.46
4200	12096	1159	34.61	1202	37.50	1244	40.46	1283	43.30	1322	46.29	1359	49.21	1394	52.05	1430	55.20	1467	58.35
4400	12672	1173	36.92	1215	39.85	1256	42.86	1296	45.94	1334	48.96	1371	52.02	1407	55.10	1441	58.20	1476	61.29
4600	13248	1188	39.41	1230	42.49	1270	45.54	1309	48.65	1347	51.81	1384	55.01	1420	58.24	1454	61.42	1488	64.59
4800	13824	1204	42.09	1245	45.22	1284	48.31	1322	51.44	1360	54.75	1397	58.09	1433	61.45	1467	64.76	1501	68.08
5000	14400	1219	44.76	1260	48.05	1299	51.28	1337	54.57	1373	57.76	1410	61.25	1446	64.76	1480	68.22	1514	71.67
5200	14976	1234	47.52	1275	50.96	1314	54.35	1352	57.79	1388	61.13	1423	64.49	1459	68.15	1493	71.74	1527	75.34
5400	15552	1251	50.56	1290	53.97	1329	57.52	1367	61.12	1403	64.61	1438	68.11	1472	71.62	1506	75.36	1540	79.10
5600	16128	1269	53.76	1306	57.20	1345	60.92	1382	64.54	1418	68.19	1453	71.85	1487	75.51	1520	79.24	1553	82.96
5800	16704	1287	57.07	1324	60.67	1360	64.28	1397	68.06	1433	71.87	1468	75.68	1502	79.50	1535	83.29	1567	87.08
6000	17280	1306	60.63	1342	64.26	1378	68.07	1413	71.84	1449	75.81	1483	79.63	1517	83.60	1550	87.54	1582	91.49
6200	17856	1324	64.17	1361	68.12	1396	71.95	1430	75.79	1464	79.70	1499	83.85	1532	87.81	1565	91.91	1597	96.01
6400	18432	1343	67.99	1379	71.96	1414	75.95	1448	79.96	1481	83.96	1514	88.01	1548	92.31	1580	96.16	1612	100.0
6600	19008	1362	71.94	1398	76.08	1433	80.25	1466	84.26	1499	88.43	1531	92.58	1563	96.75	1595	101.1	1627	105.5

*SP - Static Pressure Inches H₂O *OV - Outlet Velocity (Feet Per Minute) *CFM - Cubic Feet Per Minute

Inlet Size - 26" Dia. Outside
 Outlet Size - 21¹⁵/₁₆" x 25³/₁₆" Outside
 Wheel Diameter - 45¹/₈"
 Tip Speed = 11.81 x RPM

Inlet Area - 3.69 Sq. Ft. Outside
 Outlet Area - 3.68 Sq. Ft. Inside
 Wheel Circumference - 11.81 Ft.
 Max Safe Fan Speed - 1270 RPM

Power Rating (BHP) does not include transmission losses. Performance Ratings do not include the effects of appurtenances (accessories). All capacities based on standard air (density .075 #/cu. ft. 70°F. 29.92" Hg. Bar.). Performances shown in the color zone are those operating at maximum static efficiency. Performances shown above colored line are those operating within optimum operation range. Performance certified is for installation type D - ducted inlet, ducted outlet.

SP*.>>		1		2		3		4		5		6		7		8		9	
OV*	CFM*	RPM	BHP	RPM	BHP	RPM	BHP	RPM	BHP	RPM	BHP	RPM	BHP	RPM	BHP	RPM	BHP	RPM	BHP
1000	3710	307	0.99	421	2.02														
1200	4452	318	1.24	426	2.38	515	3.65	590	4.97										
1400	5194	331	1.53	434	2.78	519	4.16	595	5.67	661	7.20								
1600	5936	344	1.86	445	3.27	527	4.76	599	6.35	666	8.07	726	9.82	781	11.60				
1800	6678	360	2.27	456	3.78	535	5.38	607	7.15	670	8.93	730	10.83	786	12.81	837	14.78	885	16.78
2000	7420	377	2.75	469	4.39	547	6.14	615	7.97	678	9.92	735	11.91	790	14.00	842	16.18	890	18.34
2200	8162	394	3.27	483	5.08	558	6.92	625	8.89	686	10.94	743	13.09	795	15.25	846	17.54	894	19.86
2400	8904	413	3.91	497	5.81	571	7.82	637	9.94	696	12.09	751	14.32	803	16.63	852	19.02	899	21.48
2600	9646	432	4.61	513	6.65	585	8.83	648	10.99	707	13.32	760	15.64	812	18.14	860	20.61	906	23.19
2800	10388	451	5.39	530	7.60	598	9.85	661	12.21	719	14.67	772	17.16	821	19.67	868	22.26	914	25.00
3000	11130	472	6.33	547	8.63	614	11.07	675	13.56	731	16.09	783	18.69	832	21.38	878	24.10	922	26.86
3200	11872	492	7.33	566	9.82	630	12.35	689	14.98	744	17.64	795	20.36	844	23.23	889	26.04	932	28.92
3400	12614	514	8.52	584	11.06	647	13.77	703	16.46	758	19.35	808	22.18	855	25.07	901	28.15	943	31.12
3600	13356	535	9.77	603	12.45	664	15.29	720	18.20	771	21.07	821	24.09	868	27.17	912	30.24	955	33.49
3800	14098	557	11.19	623	14.00	682	16.96	736	19.96	786	23.00	835	26.18	881	29.36	924	32.52	967	35.95
4000	14840	578	12.67	642	15.60	700	18.74	753	21.90	803	25.17	849	28.36	895	31.75	938	35.10	978	38.38
4200	15582	601	14.41	663	17.48	719	20.71	770	23.95	819	27.35	864	30.69	909	34.24	951	37.68	992	41.27
4400	16324	623	16.19	683	19.43	738	22.80	788	26.20	836	29.74	881	33.30	923	36.83	965	40.48	1005	44.14
4600	17066	646	18.13	704	21.59	757	25.02	807	28.66	853	32.25	897	35.92	939	39.67	979	43.38	1019	47.25
4800	17808	670	20.31	725	23.89	777	27.47	826	31.27	870	34.88	914	38.79	955	42.63	994	46.48	1033	50.48
5000	18550	694	22.65	747	26.45	797	30.06	845	34.02	889	37.87	931	41.79	972	45.85	1010	49.78	1047	53.82
5200	19292	718	25.16	768	29.07	817	32.84	864	36.91	907	40.88	948	44.92	988	49.06	1027	53.36	1063	57.46
5400	20034	741	27.74	790	31.96	838	35.90	883	39.94	926	44.17	966	48.30	1005	52.56	1043	56.93	1079	61.24
5600	20776	766	30.72	812	35.03	859	39.14	903	43.27	945	47.61	985	51.99	1022	56.20	1060	60.80	1096	65.34
5800	21518	790	33.78	834	38.29	880	42.55	923	46.77	964	51.21	1004	55.85	1041	60.30	1077	64.83	1113	69.59
6000	22260	814	37.03	856	41.73	901	46.14	943	50.49	984	55.15	1023	59.88	1059	64.40	1094	69.00	1130	74.01
6200	23002	838	40.49	879	45.46	923	50.08	964	54.55	1003	59.09	1042	64.09	1078	68.85	1112	73.50	1146	78.38
6400	23744	862	44.15	902	49.28	944	54.06	985	58.81	1023	63.39	1061	68.47	1097	73.48	1131	78.37	1164	83.32
6600	24486	887	48.18	925	53.30	966	58.41	1006	63.28	1043	67.92	1080	73.03	1116	78.30	1150	83.44	1182	88.41

SIZE
26

SP*.>>		10		11		12		13		14		15		16		17		18	
OV*	CFM*	RPM	BHP	RPM	BHP	RPM	BHP	RPM	BHP	RPM	BHP	RPM	BHP	RPM	BHP	RPM	BHP	RPM	BHP
2000	7420	936	20.58	979	22.80														
2200	8162	940	22.25	984	24.70	1025	27.10	1065	29.58										
2400	8904	944	23.96	988	26.56	1030	29.19	1069	31.75	1108	34.46	1145	37.15	1181	39.89				
2600	9646	950	25.82	992	28.44	1034	31.23	1074	34.03	1112	36.81	1149	39.65	1185	42.54	1219	45.43	1253	48.32
2800	10388	958	27.80	999	30.55	1038	33.30	1078	36.26	1117	39.29	1154	42.29	1189	45.23	1224	48.33	1258	51.43
3000	11130	966	29.83	1007	32.75	1046	35.66	1084	38.66	1121	41.71	1158	44.86	1194	48.07	1228	51.26	1262	54.46
3200	11872	974	31.92	1015	34.99	1054	38.07	1092	41.24	1128	44.36	1164	47.65	1198	50.82	1233	54.24	1267	57.66
3400	12614	984	34.21	1023	37.30	1062	40.54	1100	43.87	1136	47.15	1172	50.62	1206	53.99	1238	57.37	1271	60.77
3600	13356	995	36.65	1034	39.93	1071	43.18	1108	46.57	1145	50.14	1180	53.64	1214	57.18	1246	60.68	1278	64.18
3800	14098	1007	39.29	1045	42.63	1082	46.06	1118	49.55	1153	53.07	1188	56.74	1222	60.44	1254	64.10	1286	67.76
4000	14840	1019	42.03	1057	45.54	1094	49.15	1129	52.69	1163	56.28	1196	59.90	1230	63.77	1262	67.59	1294	71.41
4200	15582	1030	44.72	1069	48.55	1105	52.21	1140	55.92	1174	59.68	1207	63.48	1239	67.29	1271	71.30	1303	75.31
4400	16324	1044	47.92	1080	51.52	1117	55.50	1152	59.39	1186	63.34	1219	67.31	1250	71.14	1280	75.12	1311	79.10
4600	17066	1057	51.10	1094	55.03	1129	58.89	1164	62.97	1197	66.93	1230	71.09	1262	75.26	1292	79.32	1322	83.39
4800	17808	1071	54.53	1107	58.52	1142	62.56	1175	66.49	1209	70.80	1242	75.14	1273	79.31	1303	83.65	1334	87.99
5000	18550	1085	58.09	1121	62.28	1155	66.36	1189	70.65	1221	74.78	1253	79.12	1285	83.66	1315	88.08	1345	92.50
5200	19292	1099	61.77	1135	66.16	1169	70.44	1202	74.75	1234	79.08	1266	83.60	1297	88.18	1327	92.76	1357	97.34
5400	20034	1114	65.64	1148	70.00	1183	74.66	1216	79.18	1248	83.70	1279	88.22	1309	92.72	1339	97.46	1369	102.2
5600	20776	1130	69.78	1163	74.26	1197	79.02	1230	83.74	1262	88.47	1293	93.19	1322	97.67	1351	102.7	1380	107.7
5800	21518	1147	74.25	1179	78.76	1211	83.48	1244	88.44	1275	93.16	1306	98.09	1336	102.2	1365	107.2	1393	112.2
6000	22260	1163	78.69	1196	83.61	1227	88.34	1257	93.07	1289	98.21	1320	103.3	1350	108.8	1378	113.8	1407	118.8
6200	23002	1180	83.49	1212	88.42	1244	93.59	1274	98.53	1303	103.3	1334	108.8	1363	113.3	1392	118.8	1420	124.4
6400	23744	1197	88.46	1229	93.62	1260	98.78	1290	103.3	1319	109.9	1348	114.4	1377	119.9	1405	125.0	1434	130.0
6600	24486	1214	93.60	1246	98.99	1276	104.4	1306	109.9	1335	114.4	1363	120.0	1391	125.5	1420	131.0	1448	136.6

*SP - Static Pressure Inches H₂O *OV - Outlet Velocity (Feet Per Minute) *CFM - Cubic Feet Per Minute

Inlet Size - 29" Dia. Outside
 Outlet Size - 24½" x 28" Outside
 Wheel Diameter - 50½"
 Tip Speed = 13.22 x RPM

Inlet Area - 4.59 Sq. Ft. Outside
 Outlet Area - 4.58 Sq. Ft. Inside
 Wheel Circumference - 13.22 Ft.
 Max Safe Fan Speed - 1135 RPM

Power Rating (BHP) does not include transmission losses. Performance Ratings do not include the effects of appurtenances (accessories). All capacities based on standard air (density .075 #/cu. ft. 70°F. 29.92" Hg. Bar.). Performances shown in the color zone are those operating at maximum static efficiency. Performances shown above colored line are those operating within optimum operation range. Performance certified is for installation type D - ducted inlet, ducted outlet.

SIZE
29

SP*.>>		1		2		3		4		5		6		7		8		9	
OV*	CFM*	RPM	BHP	RPM	BHP	RPM	BHP	RPM	BHP	RPM	BHP	RPM	BHP	RPM	BHP	RPM	BHP	RPM	BHP
1000	4630	275	1.27	377	2.54														
1200	5556	282	1.55	383	3.04	461	4.59	527	6.20										
1400	6482	291	1.90	389	3.56	467	5.32	533	7.14	591	9.01								
1600	7408	301	2.30	396	4.13	473	6.08	539	8.12	597	10.19	649	12.28	697	14.42				
1800	8334	312	2.74	403	4.73	479	6.88	544	9.08	602	11.36	655	13.71	703	16.06	748	18.46	790	20.89
2000	9260	326	3.29	412	5.43	486	7.74	550	10.13	608	12.62	661	15.19	709	17.74	754	20.36	796	22.98
2200	10186	340	3.90	422	6.22	494	8.70	558	11.32	614	13.93	667	16.71	715	19.48	760	22.30	802	25.14
2400	11112	356	4.63	432	7.05	503	9.75	565	12.50	621	15.34	673	18.29	721	21.26	766	24.30	808	27.34
2600	12038	372	5.44	446	8.08	512	10.85	572	13.73	628	16.79	679	19.89	727	23.10	772	26.35	814	29.61
2800	12964	388	6.33	459	9.14	522	12.07	582	15.21	636	18.38	687	21.71	734	25.07	778	28.46	820	31.93
3000	13890	405	7.36	473	10.34	534	13.46	591	16.68	644	20.02	694	23.50	741	27.09	784	30.60	826	34.31
3200	14816	423	8.54	488	11.66	547	14.95	601	18.30	654	21.90	702	25.46	748	29.17	792	33.02	833	36.85
3400	15742	441	9.84	503	13.07	560	16.53	612	20.06	663	23.76	711	27.56	756	31.43	799	35.40	840	39.45
3600	16668	459	11.27	519	14.66	574	18.30	625	22.01	673	25.80	721	29.87	765	33.87	807	37.97	847	42.12
3800	17594	477	12.81	536	16.45	588	20.15	638	24.06	684	28.00	730	32.14	774	36.39	815	40.16	855	45.01
4000	18520	496	14.57	552	18.28	604	22.29	652	26.33	697	30.43	740	34.62	784	39.13	825	43.61	863	47.96
4200	19446	515	16.48	569	20.33	619	24.43	665	28.60	710	32.96	752	37.39	794	41.98	834	46.55	873	51.32
4400	20372	533	18.44	587	22.64	636	26.95	680	31.21	724	35.77	765	40.31	803	44.77	844	49.76	882	54.60
4600	21298	553	20.73	604	24.99	652	29.49	696	34.05	737	38.55	778	43.37	816	48.11	854	53.07	892	58.18
4800	22224	573	23.20	622	27.61	668	32.18	711	36.88	751	41.62	792	46.72	829	51.56	865	56.59	902	61.87
5000	23150	594	25.98	641	30.54	685	35.16	727	40.02	766	44.89	805	50.05	843	55.34	878	60.45	912	65.68
5200	24076	614	28.83	659	33.52	702	38.31	743	43.32	782	48.49	819	53.70	856	59.08	891	64.45	924	69.75
5400	25002	634	31.87	677	36.67	719	41.63	760	46.97	798	52.27	834	57.62	870	63.17	904	68.59	937	74.15
5600	25928	655	35.28	696	40.18	737	45.32	776	50.61	814	56.22	849	61.65	883	67.20	918	73.13	951	78.97
5800	26854	675	38.75	715	43.89	755	49.20	793	54.63	830	60.34	865	66.08	898	71.77	931	77.59	964	83.70
6000	27780	696	42.62	733	47.63	773	53.28	810	58.84	846	64.65	881	70.70	913	76.43	945	82.46	978	88.86
6200	28706	716	46.53	752	51.77	791	57.58	828	63.48	863	69.39	897	75.51	929	81.54	960	87.68	991	93.93
6400	29632	737	50.89	772	56.27	810	62.32	845	68.10	879	74.09	913	80.52	945	86.85	975	93.01	1005	99.45
6600	30558	758	55.50	792	61.03	828	67.05	863	73.18	896	79.24	929	85.73	961	92.37	991	98.82	1020	105.5

SP*.>>		10		11		12		13		14		15		16		17		18	
OV*	CFM*	RPM	BHP	RPM	BHP	RPM	BHP	RPM	BHP	RPM	BHP	RPM	BHP	RPM	BHP	RPM	BHP	RPM	BHP
2000	9260	836	25.67	874	28.38														
2200	10186	842	28.03	880	30.95	916	33.86	951	36.86										
2400	11112	848	30.44	886	33.57	922	36.69	957	39.90	990	43.04	1022	46.24	1054	49.61				
2600	12038	854	32.92	891	36.14	928	39.59	962	42.87	996	46.35	1028	49.75	1060	53.33	1090	56.78	1119	60.23
2800	12964	859	35.34	897	38.88	934	42.55	968	46.03	1002	49.73	1034	53.33	1065	56.96	1095	60.70	1125	64.43
3000	13890	865	37.93	903	41.69	940	45.57	974	49.26	1008	53.17	1040	56.98	1071	60.82	1101	64.76	1131	68.71
3200	14816	871	40.58	909	44.56	945	48.51	980	52.56	1014	56.69	1046	60.71	1077	64.75	1107	68.90	1137	73.06
3400	15742	879	43.54	916	47.64	951	51.66	986	55.93	1020	60.28	1052	64.51	1083	68.77	1113	73.14	1143	77.50
3600	16668	886	46.44	923	50.76	958	55.03	992	59.37	1026	63.94	1058	68.38	1089	72.85	1119	77.32	1148	81.80
3800	17594	893	49.40	930	53.95	965	58.44	999	63.02	1032	67.67	1064	72.33	1095	77.02	1125	81.70	1154	86.39
4000	18520	901	52.62	938	57.40	973	62.13	1006	66.74	1039	71.62	1070	76.33	1101	81.25	1130	86.15	1160	91.06
4200	19446	909	55.90	945	60.76	980	65.71	1014	70.76	1046	75.65	1077	80.58	1108	85.76	1137	90.78	1166	95.81
4400	20372	919	59.62	953	64.37	987	69.37	1021	74.65	1053	79.77	1085	85.16	1115	90.33	1144	95.16	1173	100.0
4600	21298	928	63.25	963	68.45	996	73.52	1029	78.86	1061	84.21	1092	89.60	1122	94.99	1151	100.2	1180	105.5
4800	22224	938	67.20	972	72.43	1005	77.75	1037	83.13	1068	88.51	1100	94.38	1130	100.0	1159	105.6	1188	111.1
5000	23150	948	71.27	982	76.76	1015	82.33	1047	87.96	1077	93.36	1107	99.00	1137	104.4	1166	110.5	1195	116.6
5200	24076	957	75.22	992	81.21	1025	87.04	1056	92.66	1087	98.57	1116	104.4	1145	110.0	1173	116.1	1202	122.2
5400	25002	969	79.82	1001	85.53	1034	91.61	1066	97.76	1096	103.3	1126	109.9	1154	115.5	1182	122.2	1210	128.8
5600	25928	982	84.65	1012	90.39	1044	96.58	1075	102.2	1106	109.9	1135	115.5	1164	121.1	1191	127.2	1218	133.3
5800	26854	995	89.64	1025	95.64	1054	101.1	1085	108.8	1116	114.4	1145	121.1	1173	127.7	1200	133.8	1227	140.0
6000	27780	1009	95.09	1038	101.1	1067	107.7	1095	113.3	1125	120.0	1155	127.7	1183	133.3	1210	140.0	1237	146.6
6200	28706	1022	100.0	1052	106.6	1080	113.3	1108	119.9	1135	126.6	1164	133.3	1193	140.0	1220	146.6	1247	153.3
6400	29632	1036	106.6	1065	112.2	1093	119.9	1121	126.6	1147	132.2	1174	139.9	1202	146.6	1229	153.3	1256	160.0
6600	30558	1049	111.1	1079	119.9	1107	125.5	1134	132.2	1160	139.9	1186	146.6	1212	153.3	1239	160.5	1266	167.7

*SP - Static Pressure Inches H₂O *OV - Outlet Velocity (Feet Per Minute) *CFM - Cubic Feet Per Minute

Inlet Size - 33" Dia. Outside
 Outlet Size - 27³/₄" x 31¹/₈" Outside
 Wheel Diameter - 57"
 Tip Speed = 14.92 x RPM

Inlet Area - 5.94 Sq. Ft. Outside
 Outlet Area - 5.94 Sq. Ft. Inside
 Wheel Circumference - 14.92 Ft.
 Max Safe Fan Speed - 1005 RPM

Power Rating (BHP) does not include transmission losses. Performance Ratings do not include the effects of appurtenances (accessories). All capacities based on standard air (density .075 #/cu. ft. 70°F. 29.92" Hg. Bar.). Performances shown in the color zone are those operating at maximum static efficiency. Performances shown above colored line are those operating within optimum operation range. Performance certified is for installation type D - ducted inlet, ducted outlet.

SP*.>>		1		2		3		4		5		6		7		8		9	
OV*	CFM*	RPM	BHP	RPM	BHP	RPM	BHP	RPM	BHP	RPM	BHP	RPM	BHP	RPM	BHP	RPM	BHP	RPM	BHP
1000	5990	244	1.64	334	3.28														
1200	7188	251	2.03	340	3.94	409	5.93	467	7.99										
1400	8386	259	2.48	345	4.60	414	6.86	472	9.18	524	11.62								
1600	9584	267	2.97	352	5.37	419	7.83	478	10.49	529	13.13	576	15.90	618	18.61				
1800	10782	278	3.58	358	6.14	425	8.90	483	11.77	534	14.68	581	17.72	624	20.80	663	23.81	701	27.02
2000	11980	291	4.32	367	7.11	432	10.07	488	13.11	540	16.38	586	19.60	629	22.95	669	26.33	706	29.69
2200	13178	304	5.14	375	8.08	439	11.30	495	14.64	545	18.04	592	21.65	634	25.15	674	28.81	711	32.44
2400	14376	318	6.08	385	9.22	447	12.66	502	16.24	552	19.95	597	23.65	640	27.55	679	31.35	717	35.39
2600	15574	332	7.12	397	10.53	456	14.18	509	17.91	558	21.81	603	25.80	645	29.88	685	34.10	722	38.27
2800	16772	347	8.33	409	11.94	464	15.69	517	19.73	565	23.86	610	28.15	651	32.40	690	36.78	727	41.22
3000	17970	362	9.67	422	13.55	475	17.49	526	21.76	573	26.10	616	30.44	658	35.13	696	39.65	733	44.42
3200	19168	378	11.22	436	15.33	487	19.48	535	23.89	581	28.42	624	33.10	665	37.96	703	42.77	739	47.65
3400	20366	395	13.01	450	17.24	499	21.59	545	26.16	590	30.98	632	35.83	671	40.70	710	46.00	746	51.18
3600	21564	411	14.87	464	19.29	512	23.97	557	28.76	599	33.67	641	38.85	680	44.04	716	49.12	753	54.80
3800	22762	428	17.02	479	21.62	525	26.44	569	31.50	609	36.50	650	41.98	688	47.30	725	52.91	759	58.31
4000	23960	444	19.22	494	24.12	539	29.18	581	34.39	621	39.73	659	45.25	697	50.89	733	56.61	767	62.33
4200	25158	461	21.73	509	26.79	553	32.09	593	37.42	633	43.12	670	48.83	706	54.62	742	60.67	776	66.72
4400	26356	479	24.58	525	29.81	568	35.36	607	40.91	645	46.68	682	52.74	715	58.41	751	64.87	785	72.25
4600	27554	497	27.63	541	33.03	583	38.83	621	44.56	658	50.63	694	56.83	727	62.83	760	69.22	793	75.65
4800	28752	515	30.92	557	36.47	597	42.29	635	48.41	670	54.49	706	61.09	739	67.44	770	73.72	802	80.48
5000	29950	533	34.45	574	40.34	612	46.16	650	52.69	684	58.91	718	65.54	751	72.23	782	78.86	812	85.65
5200	31147	551	38.23	590	44.23	628	50.48	664	56.95	699	63.82	730	70.16	763	77.22	794	84.20	824	91.34
5400	32346	569	42.28	607	48.59	644	55.06	679	61.68	713	68.68	744	75.39	775	82.41	806	89.75	835	96.89
5600	33544	588	46.83	624	53.22	660	59.88	694	66.66	727	73.77	758	80.86	788	88.13	818	95.50	847	102.2
5800	34742	606	51.44	641	58.13	676	64.96	709	71.87	742	79.41	773	86.89	802	94.23	831	101.1	860	109.9
6000	35940	625	56.61	657	63.03	693	70.62	725	77.66	757	85.30	787	92.85	816	100.0	843	108.8	872	116.6
6200	37138	643	61.82	675	68.75	709	76.25	741	83.73	771	91.11	802	99.41	830	107.7	857	114.4	884	123.3
6400	38336	662	67.65	693	74.73	726	82.51	757	90.09	786	97.52	816	105.5	844	113.3	871	122.2	897	130.0
6600	39534	681	73.82	711	81.05	742	88.72	773	96.75	802	104.4	831	113.3	859	121.1	885	129.9	911	138.8

SIZE
 33

SP*.>>		10		11		12		13		14		15		16		17		18	
OV*	CFM*	RPM	BHP	RPM	BHP	RPM	BHP	RPM	BHP	RPM	BHP	RPM	BHP	RPM	BHP	RPM	BHP	RPM	BHP
2000	11980	741	33.10	775	36.64														
2200	13178	747	36.24	780	39.90	812	43.68	843	47.54	873	51.47								
2400	14376	752	39.32	786	43.31	818	47.45	849	51.58	878	55.60	907	59.84	935	64.11				
2600	15574	757	42.47	791	46.83	823	51.14	853	55.54	883	59.81	912	64.32	940	68.86	966	73.40	993	77.93
2800	16772	763	45.87	796	50.33	828	54.90	859	59.58	889	64.32	917	68.89	945	73.69	972	78.49	998	83.29
3000	17970	768	49.17	802	54.10	834	58.96	864	63.69	894	68.71	923	73.78	950	78.61	977	83.68	1003	88.74
3200	19168	774	52.74	807	57.76	839	62.89	870	68.12	899	73.18	928	78.52	956	83.89	982	89.09	1008	94.29
3400	20366	780	56.35	813	61.69	844	66.89	875	72.41	905	77.99	933	83.36	961	89.00	988	94.50	1014	100.0
3600	21564	787	60.28	819	65.67	851	71.44	881	77.04	910	82.64	939	88.56	966	94.20	993	99.85	1048	137.7
3800	22762	793	64.07	826	70.01	857	75.81	887	81.70	916	87.64	944	93.58	972	99.79	998	105.4	1024	111.1
4000	23960	800	68.21	833	74.46	864	80.56	894	86.75	922	92.69	950	98.94	977	105.5	1003	112.1	1030	118.8
4200	25158	808	72.68	839	78.75	870	85.14	900	91.63	929	98.16	957	104.4	984	111.1	1010	117.7	1035	124.4
4400	26356	817	77.54	847	83.65	877	90.13	907	96.92	936	103.3	963	110.0	990	117.7	1016	123.8	1041	130.0
4600	27554	825	82.26	856	88.99	885	95.49	914	102.2	942	109.9	970	116.6	997	123.3	1022	130.5	1048	137.7
4800	28752	834	87.42	865	94.49	894	101.1	922	108.8	949	115.5	977	122.2	1003	129.9	1029	137.1	1055	144.4
5000	29950	843	92.74	873	99.81	902	106.6	930	114.4	958	121.1	984	128.8	1010	136.6	1035	143.8	1061	151.1
5200	31147	852	98.22	882	105.5	911	113.3	939	120.0	966	128.8	992	135.5	1017	142.2	1042	150.5	1068	158.8
5400	32346	863	104.4	891	111.1	920	119.9	948	127.7	975	135.5	1001	142.2	1026	150.0	1050	158.3	1075	166.6
5600	33544	875	110.0	902	118.8	929	125.5	957	134.4	983	141.1	1009	149.9	1035	158.8	1059	166.6	1083	174.4
5800	34742	887	117.7	914	125.5	939	132.2	965	140.0	992	149.9	1018	157.7	1043	165.5	1067	173.8	1091	182.2
6000	35940	899	124.4	925	132.2	951	140.0	975	148.8	1001	156.6	1027	165.5	1052	174.4	1076	182.7	1100	191.1
6200	37138	911	131.1	937	139.9	963	148.8	987	156.6	1010	164.4	1036	173.3	1061	182.2	1085	191.1	1109	200.0
6400	38336	924	139.9	950	147.7	975	156.6	999	164.4	1022	173.3	1045	181.1	1070	191.1	1093	200.5	1117	209.9
6600	39534	936	146.6	962	155.5	987	164.4	1011	173.3	1034	182.2	1057	191.1	1079	199.9	1102	209.3	1126	218.8

*SP - Static Pressure Inches H₂O *OV - Outlet Velocity (Feet Per Minute) *CFM - Cubic Feet Per Minute

Inlet Size - 37" Dia. Outside
 Outlet Size - 31 1/4" x 35 13/16" Outside
 Wheel Diameter - 64 3/8"
 Tip Speed = 16.85 x RPM

Inlet Area - 7.47 Sq. Ft. Outside
 Outlet Area - 7.54 Sq. Ft. Inside
 Wheel Circumference - 16.85 Ft.
 Max Safe Fan Speed - 890 RPM

Power Rating (BHP) does not include transmission losses. Performance Ratings do not include the effects of appurtenances (accessories). All capacities based on standard air (density .075 #/cu. ft. 70°F. 29.92" Hg. Bar.). Performances shown in the color zone are those operating at maximum static efficiency. Performances shown above colored line are those operating within optimum operation range. Performance certified is for installation type D - ducted inlet, ducted outlet.

SIZE
37

SP*.>>		1		2		3		4		5		6		7		8		9	
OV*	CFM*	RPM	BHP	RPM	BHP	RPM	BHP	RPM	BHP	RPM	BHP	RPM	BHP	RPM	BHP	RPM	BHP	RPM	BHP
1000	7590	216	2.08	296	4.17														
1200	9108	222	2.57	301	4.99	362	7.52	414	10.18										
1400	10626	229	3.14	305	5.81	366	8.67	418	11.66	464	14.76								
1600	12144	236	3.75	311	6.77	371	9.94	423	13.29	468	16.63	509	20.06	547	23.61				
1800	13662	246	4.54	317	7.80	376	11.27	427	14.88	473	18.66	514	22.44	552	26.33	587	30.22	620	34.19
2000	15180	257	5.45	324	8.94	382	12.73	432	16.63	478	20.78	519	24.91	557	29.14	592	33.37	625	37.68
2200	16698	268	6.45	332	10.25	388	14.27	438	18.55	482	22.82	523	27.30	561	31.87	596	36.43	630	41.27
2400	18216	280	7.61	340	11.62	395	15.98	444	20.55	488	25.21	528	29.91	566	34.85	601	39.76	634	44.74
2600	19734	293	8.97	351	13.32	403	17.91	450	22.63	494	27.68	534	32.77	571	37.91	606	43.18	639	48.52
2800	21252	306	10.48	361	15.03	410	19.80	457	24.93	500	30.24	539	35.52	576	41.04	611	46.70	644	52.40
3000	22770	320	12.25	372	17.00	420	22.14	465	27.50	506	32.88	545	38.55	582	44.46	616	50.27	648	56.12
3200	24288	334	14.19	384	19.19	430	24.55	473	30.20	514	35.99	551	41.69	588	47.99	622	54.18	654	60.41
3400	25806	348	16.32	397	21.70	441	27.29	482	33.14	522	39.26	559	45.36	594	51.64	628	58.21	660	64.81
3600	27324	362	18.64	410	24.40	452	30.21	492	36.30	529	42.42	567	49.18	601	55.61	634	62.37	666	69.35
3800	28842	377	21.34	422	27.10	463	33.24	502	39.62	538	46.08	574	52.89	609	60.01	641	66.90	672	74.01
4000	30360	392	24.26	435	30.20	476	36.84	513	43.35	549	50.27	582	57.02	616	64.27	648	71.55	678	78.75
4200	31878	406	27.24	449	33.72	488	40.43	524	47.29	559	54.39	592	61.68	624	68.99	656	76.70	686	84.31
4400	33396	421	30.63	463	37.50	501	44.48	536	51.62	570	59.00	602	66.42	632	73.86	664	82.03	694	90.07
4600	34914	437	34.48	477	41.53	514	48.78	548	56.13	581	63.84	613	71.72	642	79.23	671	87.15	701	95.60
4800	36432	453	38.63	491	45.82	527	53.34	561	61.18	592	68.88	623	76.88	653	85.20	681	93.39	709	101.1
5000	37950	469	43.09	506	50.69	540	58.14	573	66.17	604	74.34	634	82.64	663	91.02	691	99.64	717	107.7
5200	39468	485	47.87	520	55.55	554	63.55	586	71.76	616	80.05	645	88.65	674	97.49	701	106.6	727	114.4
5400	40986	501	52.99	535	61.04	568	69.27	599	77.64	629	86.44	657	95.15	685	104.4	712	113.3	738	122.2
5600	42504	517	58.45	549	66.50	582	75.31	612	83.81	642	93.13	669	101.1	696	111.1	723	120.0	748	129.9
5800	44022	534	64.64	564	72.65	596	81.66	625	90.28	654	99.68	682	109.9	707	118.8	733	128.8	759	138.8
6000	45540	550	70.85	579	79.16	610	88.34	639	97.50	667	106.6	694	116.6	720	126.6	744	136.6	770	146.6
6200	47058	566	77.44	594	86.00	625	95.82	653	105.5	680	114.4	707	124.4	732	134.4	756	144.4	781	155.5
6400	48576	583	84.85	610	93.57	639	103.3	667	113.3	693	122.2	720	133.3	745	143.3	769	154.4	791	163.3
6600	50094	599	92.26	626	101.1	654	111.1	681	121.1	707	131.1	733	142.2	758	153.3	781	163.3	804	174.4

SP*.>>		10		11		12		13		14		15		16		17		18	
OV*	CFM*	RPM	BHP	RPM	BHP	RPM	BHP	RPM	BHP	RPM	BHP	RPM	BHP	RPM	BHP	RPM	BHP	RPM	BHP
2000	15180	656	42.00	686	46.48														
2200	16698	661	45.92	691	50.74	719	55.46	746	60.25	773	65.35								
2400	18216	665	49.73	695	54.88	724	60.17	751	65.30	777	70.48	803	75.95	827	81.15				
2600	19734	670	53.85	700	59.36	728	64.73	756	70.47	782	75.98	807	81.51	832	87.33	855	92.93	878	98.53
2800	21252	675	58.08	705	63.94	733	69.66	760	75.46	786	81.30	812	87.47	836	93.31	860	99.40	883	105.5
3000	22770	680	62.42	709	68.35	738	74.71	765	80.85	791	87.04	816	93.23	841	99.75	864	105.98	888	112.2
3200	24288	684	66.57	714	73.15	742	79.55	770	86.36	796	92.90	821	99.43	846	106.6	869	113.25	892	119.9
3400	25806	690	71.34	719	78.03	747	84.81	774	91.65	801	98.89	826	105.5	850	112.2	874	119.40	897	126.6
3600	27324	696	76.25	725	83.32	752	90.15	779	97.39	805	104.4	831	112.2	855	119.9	879	127.15	902	134.4
3800	28842	702	81.29	731	88.74	758	95.94	785	103.3	810	110.0	835	118.8	860	126.6	883	133.85	906	141.1
4000	30360	708	86.47	736	93.93	764	101.1	790	109.9	816	117.7	841	125.5	864	133.3	887	141.60	911	149.9
4200	31878	715	92.12	742	99.62	770	107.7	796	115.5	822	124.4	846	132.2	870	140.0	893	148.85	916	157.7
4400	33396	722	97.89	749	105.5	776	114.4	802	122.2	828	131.1	852	139.9	876	148.8	898	157.15	921	165.5
4600	34914	730	104.4	757	112.2	783	120.0	808	129.9	833	138.8	858	147.7	882	156.6	904	165.50	927	174.4
4800	36432	737	110.0	764	119.9	790	127.7	815	136.6	839	145.5	864	154.4	888	164.4	910	173.30	933	182.2
5000	37950	745	117.7	772	126.6	798	135.5	823	144.4	847	153.3	870	162.2	893	172.2	916	181.65	939	191.1
5200	39468	753	124.4	780	133.3	805	142.2	830	152.2	854	161.1	877	171.1	900	181.1	922	191.10	945	201.1
5400	40986	763	131.1	787	140.0	813	150.0	838	160.0	862	170.0	885	180.0	907	190.0	928	199.95	950	209.9
5600	42504	773	139.9	797	149.9	821	159.9	846	169.9	869	179.9	892	189.9	915	200.0	936	209.95	957	219.9
5800	44022	783	147.7	807	157.7	829	167.7	853	177.7	877	188.8	900	199.9	922	209.9	943	219.95	965	230.0
6000	45540	794	156.6	817	166.6	840	177.7	861	186.6	885	198.8	908	209.9	930	220.0	951	230.55	972	241.1
6200	47058	805	165.5	828	176.6	850	186.6	872	197.7	893	207.7	915	218.8	938	230.0	959	241.10	980	252.2
6400	48576	815	174.4	838	185.5	861	197.7	882	207.7	903	218.8	923	229.9	945	240.0	966	252.20	988	264.4
6600	50094	826	184.4	849	196.6	882	207.7	893	218.8	913	229.9	933	240.0	953	252.2	974	264.40	995	276.6

*SP - Static Pressure Inches H₂O *OV - Outlet Velocity (Feet Per Minute) *CFM - Cubic Feet Per Minute

Inlet Size - 41" Dia. Outside
 Outlet Size - 34½" x 39⅞" Outside
 Wheel Diameter - 71"
 Tip Speed = 18.59 x RPM

Inlet Area - 9.17 Sq. Ft. Outside
 Outlet Area - 9.15 Sq. Ft. Inside
 Wheel Circumference - 18.59 Ft.
 Max Safe Fan Speed - 804 RPM

Power Rating (BHP) does not include transmission losses. Performance Ratings do not include the effects of appurtenances (accessories). All capacities based on standard air (density .075 #/cu. ft. 70°F. 29.92" Hg. Bar.). Performances shown in the color zone are those operating at maximum static efficiency. Performances shown above colored line are those operating within optimum operation range. Performance certified is for installation type D - ducted inlet, ducted outlet.

SP*.>>		1		2		3		4		5		6		7		8		9	
OV*	CFM*	RPM	BHP	RPM	BHP	RPM	BHP	RPM	BHP	RPM	BHP	RPM	BHP	RPM	BHP	RPM	BHP	RPM	BHP
1000	9152	196	2.51																
1200	10982	201	3.06	272	6.01	328	9.07												
1400	12813	207	3.76	277	7.04	332	10.52	379	14.11										
1600	14643	214	4.55	282	8.16	336	12.02	383	16.05	425	20.14	462	24.27	496	28.50				
1800	16474	222	5.42	287	9.35	341	13.60	387	17.95	428	22.45	466	27.10	500	31.75	532	36.49	562	41.29
2000	18304	232	6.50	293	10.73	346	15.30	391	20.02	432	24.95	470	30.03	504	35.07	536	40.24	566	45.42
2200	20134	242	7.71	300	12.29	351	17.20	397	22.38	437	27.53	474	33.03	509	38.51	541	44.08	570	49.69
2400	21965	253	9.15	307	13.94	358	19.27	402	24.71	442	30.32	479	36.15	513	42.02	545	48.03	575	54.04
2600	23795	265	10.75	317	15.97	364	21.45	407	27.14	447	33.19	483	39.32	517	45.66	549	52.09	579	58.53
2800	25626	276	12.51	326	18.07	371	23.86	414	30.07	452	36.33	489	42.91	522	49.56	553	56.26	583	63.12
3000	27456	288	14.55	336	20.44	380	26.61	420	32.97	458	39.57	494	46.45	527	53.55	558	60.49	588	67.82
3200	29286	301	16.88	347	23.05	389	29.55	427	36.17	465	43.29	499	50.33	532	57.66	563	65.27	592	72.84
3400	31117	314	19.45	358	25.84	398	32.67	435	39.65	472	46.97	506	54.48	538	62.13	568	69.97	597	77.98
3600	32947	326	22.28	369	28.98	408	36.17	445	43.51	479	51.00	513	59.04	544	66.95	574	75.05	602	83.26
3800	34778	339	25.32	381	32.52	418	41.81	454	47.56	487	55.35	519	63.53	551	71.93	580	80.27	608	88.97
4000	36608	353	28.80	393	36.13	430	44.06	464	52.05	496	60.15	526	68.43	558	77.35	587	86.20	614	94.80
4200	38438	366	32.58	405	40.19	440	48.29	473	56.53	505	65.15	535	73.91	565	82.98	593	92.01	621	101.4
4400	40269	379	36.45	418	44.75	452	53.27	484	61.69	515	70.71	544	79.68	571	88.50	600	98.36	627	107.9
4600	42099	393	40.98	430	49.40	464	58.29	495	67.31	524	76.20	553	85.73	580	95.10	607	104.9	634	115.0
4800	43929	408	45.86	442	54.58	475	63.61	506	72.90	534	82.27	563	92.35	590	101.9	615	111.8	642	122.3
5000	45760	422	51.35	456	60.37	487	69.50	517	79.11	545	88.73	573	98.93	600	109.3	624	119.4	649	129.8
5200	47590	437	56.99	469	66.26	499	75.73	528	85.63	556	95.85	583	106.1	609	116.7	634	127.4	657	137.8
5400	49421	451	63.00	482	72.48	511	82.29	541	92.84	568	103.3	593	113.9	619	124.8	643	135.5	666	146.5
5600	51251	466	69.74	495	79.72	524	89.58	552	100.0	579	111.1	604	121.8	628	132.8	653	144.5	676	156.1
5800	53081	480	76.60	509	86.76	537	97.25	564	107.9	590	119.2	615	130.6	639	141.8	662	153.3	686	165.4
6000	54912	495	84.25	521	94.15	550	105.3	576	116.3	602	127.7	627	139.7	649	151.0	672	163.0	696	175.6
6200	56742	509	91.97	535	102.3	563	113.8	589	125.4	614	137.1	638	149.2	661	161.1	683	173.3	705	185.6
6400	58573	524	100.5	549	111.2	576	123.1	601	134.6	625	146.4	649	159.1	672	171.6	693	183.8	715	196.5
6600	60403	539	109.7	563	120.6	589	132.5	614	144.6	637	156.6	661	169.4	684	182.5	705	195.3	725	208.5

SIZE
41

SP*.>>		10		11		12		13		14		15		16		17		18	
OV*	CFM*	RPM	BHP	RPM	BHP	RPM	BHP	RPM	BHP	RPM	BHP	RPM	BHP	RPM	BHP	RPM	BHP	RPM	BHP
2000	18304	595	50.74	622	56.10														
2200	20134	599	55.41	626	61.18	652	66.93	676	72.86										
2400	21965	603	60.17	630	66.36	656	72.52	681	78.87	704	85.08	727	91.40	750	98.06				
2600	23795	607	65.07	634	71.44	660	78.26	684	84.74	708	91.62	731	98.34	754	105.4	775	112.2	796	119.0
2800	25626	611	69.86	638	76.85	664	84.11	689	90.99	713	98.30	735	105.4	757	112.5	778	120.0	800	127.3
3000	27456	615	74.98	642	82.41	669	90.08	693	97.37	717	105.1	740	112.6	762	120.2	783	128.0	804	135.8
3200	29286	620	80.21	647	88.08	672	95.89	697	103.8	721	112.0	744	120.0	766	127.9	788	136.2	809	144.4
3400	31117	625	86.06	652	94.17	676	102.1	701	110.5	725	119.1	748	127.5	770	135.9	792	144.6	813	153.2
3600	32947	630	91.80	656	100.3	681	108.7	706	117.3	730	126.3	753	135.1	775	144.0	796	152.8	817	161.7
3800	34778	635	97.65	661	106.6	686	115.5	711	124.5	734	133.7	757	142.9	779	152.2	800	161.5	821	170.8
4000	36608	641	104.0	667	113.4	692	122.8	716	131.9	739	141.5	761	150.8	783	160.6	804	170.3	825	180.0
4200	38438	647	110.5	672	120.1	697	129.8	721	139.8	744	149.5	766	159.2	788	169.5	808	179.5	829	189.4
4400	40269	654	117.8	678	127.2	702	137.1	726	147.5	749	157.6	772	168.3	793	178.5	814	188.1	834	197.7
4600	42099	660	125.0	685	135.3	708	145.3	732	155.8	755	166.4	777	177.1	798	187.7	818	198.1	839	208.5
4800	43929	667	132.8	691	143.1	715	153.6	738	164.3	760	174.9	782	186.5	804	197.6	824	208.6	845	219.6
5000	45760	674	140.8	698	151.7	722	162.7	745	173.8	766	184.5	787	195.6	809	206.4	830	218.5	850	230.5
5200	47590	681	148.6	706	160.5	729	172.0	751	183.1	773	194.8	794	206.3	814	217.4	834	229.4	855	241.5
5400	49421	689	157.7	712	169.0	735	181.0	758	193.2	780	204.1	801	217.2	821	228.3	841	241.4	861	254.6
5600	51251	698	167.3	720	178.6	743	190.9	765	202.0	787	212.2	807	228.3	828	239.4	847	251.5	866	263.5
5800	53081	708	177.1	729	189.0	750	199.8	772	215.0	794	226.1	814	239.3	834	252.4	854	264.6	873	276.7
6000	54912	718	187.9	738	199.8	759	212.8	779	223.9	800	237.6	822	252.4	841	263.5	860	276.6	880	289.8
6200	56742	727	197.6	748	210.7	768	223.9	788	237.0	807	250.2	828	263.4	849	276.7	868	289.9	887	303.0
6400	58573	737	210.7	757	221.7	777	237.0	797	250.2	816	261.3	835	276.5	855	289.8	874	303.0	893	316.3
6600	60403	746	219.6	767	237.0	787	248.0	807	261.3	825	276.5	844	289.7	862	303.0	881	317.2	900	331.5

*SP - Static Pressure Inches H₂O *OV - Outlet Velocity (Feet Per Minute) *CFM - Cubic Feet Per Minute

MATERIAL HANDLING FAN

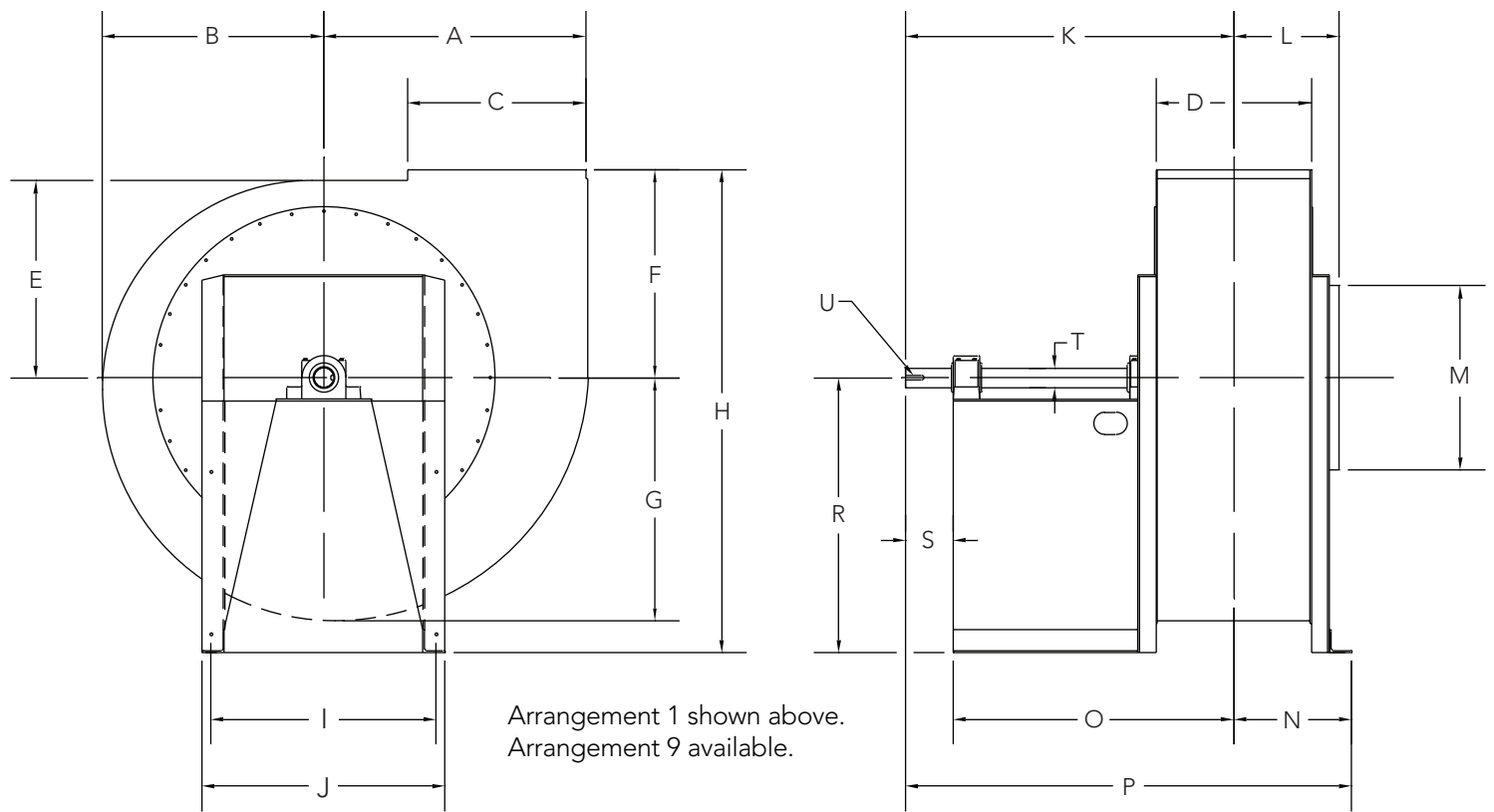

Note: All dimensions in inches.
All fans shipped with Outlet Flanges unless otherwise specified.

Material Handling Fan													
Size No.	A	B	C	D	E	F	G	H	I	J	K	L	M
11	15 ¹¹ / ₁₆	13 ⁷ / ₁₆	10 ⁷ / ₈	9 ⁷ / ₁₆	12 ¹ / ₈	14 ⁵ / ₈	14 ¹ / ₂	33 ³ / ₈	15 ¹ / ₂	17	31 ¹ / ₄	7 ¹ / ₂	11
13	18 ⁷ / ₁₆	15 ⁷ / ₈	12 ¹³ / ₁₆	11	13 ³ / ₄	16 ¹ / ₄	17 ⁵ / ₁₆	37 ¹ / ₄	17	19	32 ¹¹ / ₁₆	8 ⁵ / ₁₆	13
15	21 ⁵ / ₁₆	18 ¹ / ₈	14 ³ / ₄	12 ³ / ₄	15 ⁷ / ₈	18 ³ / ₈	19 ¹⁵ / ₁₆	42 ¹¹ / ₁₆	19 ¹ / ₂	21	35 ⁷ / ₈	9 ³ / ₁₆	15
17	24 ¹ / ₄	20 ¹ / ₂	16 ⁹ / ₁₆	14 ⁷ / ₁₆	17 ¹⁵ / ₁₆	20 ⁷ / ₁₆	22 ⁹ / ₁₆	48	21 ¹ / ₂	23	35 ⁷ / ₈	10	17
19	27	22 ⁷ / ₈	18 ³ / ₈	16	20	22 ¹ / ₂	25 ¹ / ₈	52 ⁵ / ₈	23 ¹ / ₂	25	37 ³ / ₄	10 ¹³ / ₁₆	19
21	30	25	20 ¹ / ₄	17 ¹¹ / ₁₆	22 ⁵ / ₈	25 ⁵ / ₈	27 ⁵ / ₈	59 ¹ / ₄	28	31	40 ¹ / ₂	13 ³ / ₈	21
23	32 ³ / ₄	26 ⁵ / ₈	22 ¹ / ₄	19 ¹ / ₂	23 ³ / ₈	26 ⁷ / ₈	30	62 ⁷ / ₈	30	33	44 ⁷ / ₈	14 ⁵ / ₁₆	23
26	37	31	25 ³ / ₁₆	21 ¹⁵ / ₁₆	27 ³ / ₈	29 ⁷ / ₈	35 ¹ / ₈	70	31	34	46 ³ / ₃₂	15 ¹ / ₂	26
29	41 ³ / ₈	34 ⁵ / ₈	28	24 ¹ / ₂	30 ¹ / ₂	33	39	81	36	39	52 ¹ / ₂	16 ¹³ / ₁₆	29
33	48	39	31 ⁷ / ₈	27 ³ / ₄	34 ¹ / ₂	38	43 ¹ / ₂	89	40	43	56	18 ⁷ / ₁₆	33
37	53 ¹ / ₈	44	35 ¹³ / ₁₆	31 ¹ / ₄	39	41 ¹ / ₂	48 ³ / ₈	96 ⁷ / ₈	45	49	63 ⁷ / ₈	21 ³ / ₁₆	37
41	58 ³ / ₄	49 ¹ / ₈	39 ⁹ / ₁₆	34 ¹ / ₂	43 ³ / ₄	46 ¹ / ₄	54	107 ¹ / ₄	50	54	72 ⁷ / ₈	23 ¹ / ₂	41

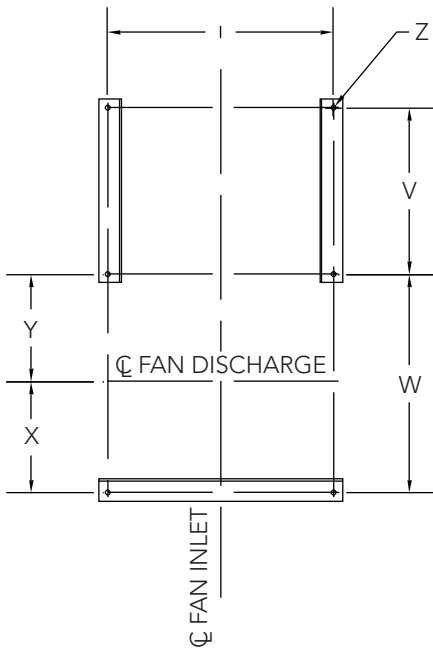

Only certified dimensions to be used for construction.
 Certified Drawings available upon request.

N	O	P	R	S	T	U	V	W	X	Y	Z	Weight	Size No.
9 1/32	26 5/32	40 9/32	18 3/4	5 3/32	1 11/16	3/8 X 3/16	16 7/8	16 9/16	8 9/32	8 9/32	11/16	410	11
9 13/16	27 11/16	42 1/2	21	5	1 11/16	3/8 X 3/16	16 3/8	18 7/8	9 1/16	9 13/16	11/16	509	13
10 11/16	29 11/16	46 9/16	24 5/16	6 3/16	1 15/16	1/2 X 1/4	18 3/4	19 7/8	9 15/16	9 15/16	11/16	629	15
11 17/32	30 21/32	47 13/32	27 9/16	5 7/32	1 15/16	1/2 X 1/4	18 1/4	21 7/8	10 25/32	11 3/32	11/16	729	17
12 5/16	32	50 1/16	30 1/8	5 3/4	2 3/16	1/2 X 1/4	19 7/16	23 1/8	11 5/8	11 5/8	11/16	929	19
15 5/32	34 13/32	55 21/32	33 5/8	6 3/32	2 7/16	5/8 X 5/16	18	28 1/16	13 21/32	14 13/32	11/16	1180	21
16	38 13/16	60 13/16	36	6	2 7/16	5/8 X 5/16	21 9/16	29 3/4	14 1/2	15 1/4	11/16	1360	23
17 9/32	40 3/32	63 3/8	40 1/8	6	2 15/16	3/4 X 3/8	20 1/16	33 1/16	15 25/32	17 9/32	11/16	1659	26
18 9/16	45	71 1/16	48	7 1/2	2 15/16	3/4 X 3/8	25 3/16	34 7/8	17 1/16	17 13/16	13/16	2109	29
20 3/16	49 7/16	76 3/16	51	6 9/16	3 7/16	7/8 X 7/16	28	38 1/8	18 11/16	19 7/16	13/16	2779	33
23 15/16	54 3/4	87 13/16	55 3/8	9 1/8	3 7/16	7/8 X 7/16	30 9/16	44 1/8	21 15/16	22 3/16	13/16	3269	37
26 5/8	62 3/8	99 5/8	61	10 1/2	4 7/16	1 X 1/2	36 7/8	48 3/8	24 5/8	23 3/4	1 1/16	5890	41

INLET FLANGE

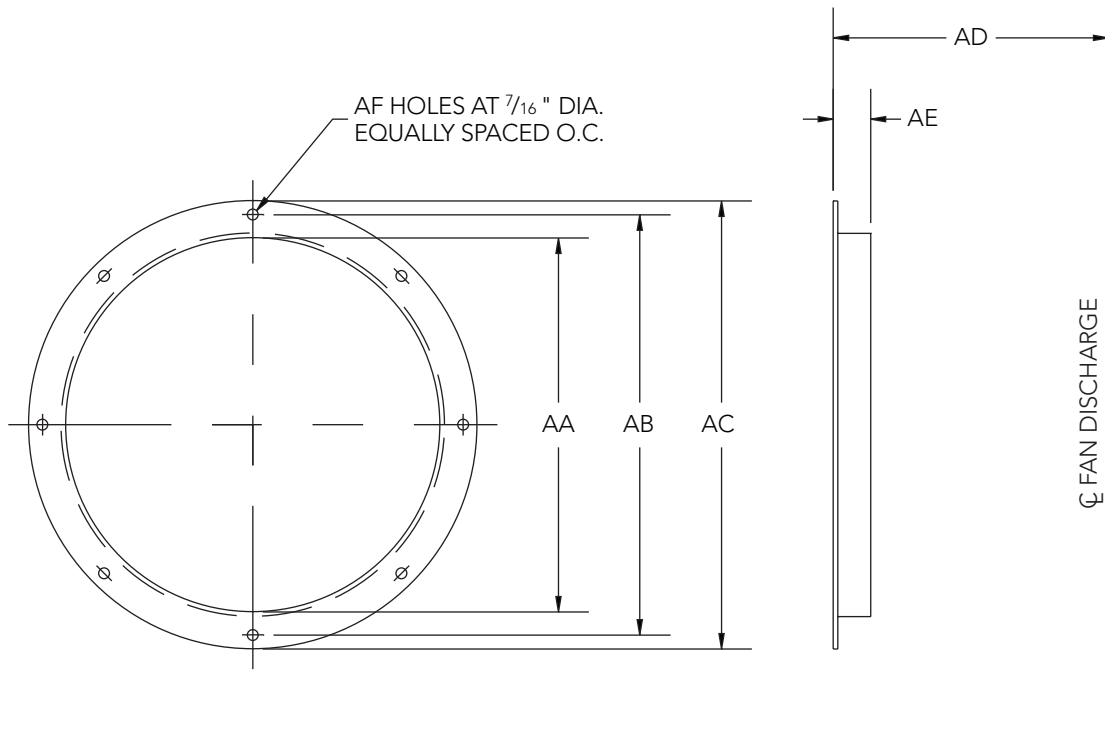

Inlet Flange						
Fan Size	AA	AB	AC	AD	AE	AF
11	11 $\frac{1}{8}$	12 $\frac{3}{4}$	14 $\frac{1}{8}$	8	1 $\frac{1}{4}$	6
13	13 $\frac{1}{8}$	15	16 $\frac{1}{8}$	8 $\frac{13}{16}$	1 $\frac{1}{2}$	6
15	15 $\frac{1}{8}$	17	18 $\frac{1}{8}$	9 $\frac{11}{16}$	1 $\frac{1}{2}$	8
17	17 $\frac{1}{8}$	19	20 $\frac{1}{8}$	10 $\frac{1}{2}$	1 $\frac{1}{2}$	8
19	19 $\frac{1}{8}$	20 $\frac{3}{4}$	22 $\frac{1}{8}$	11 $\frac{5}{16}$	1 $\frac{1}{2}$	12
21	21 $\frac{1}{8}$	22 $\frac{3}{4}$	24 $\frac{1}{8}$	13 $\frac{7}{8}$	1 $\frac{1}{2}$	12
23	23 $\frac{1}{8}$	24 $\frac{7}{8}$	26 $\frac{1}{8}$	14 $\frac{13}{16}$	1 $\frac{1}{2}$	12
26	26 $\frac{1}{8}$	28 $\frac{3}{8}$	30 $\frac{1}{8}$	16	2	16
29	29 $\frac{1}{8}$	31 $\frac{3}{8}$	33 $\frac{1}{8}$	17 $\frac{5}{16}$	2	16
33	33 $\frac{1}{8}$	35 $\frac{3}{8}$	37 $\frac{1}{8}$	18 $\frac{15}{16}$	2	16
37	37 $\frac{1}{8}$	39 $\frac{3}{8}$	41 $\frac{1}{8}$	21 $\frac{11}{16}$	2	24
41	41 $\frac{1}{8}$	43 $\frac{3}{8}$	45 $\frac{1}{8}$	25 $\frac{1}{4}$	2	24

Note: All dimensions in inches.

OUTLET FLANGE

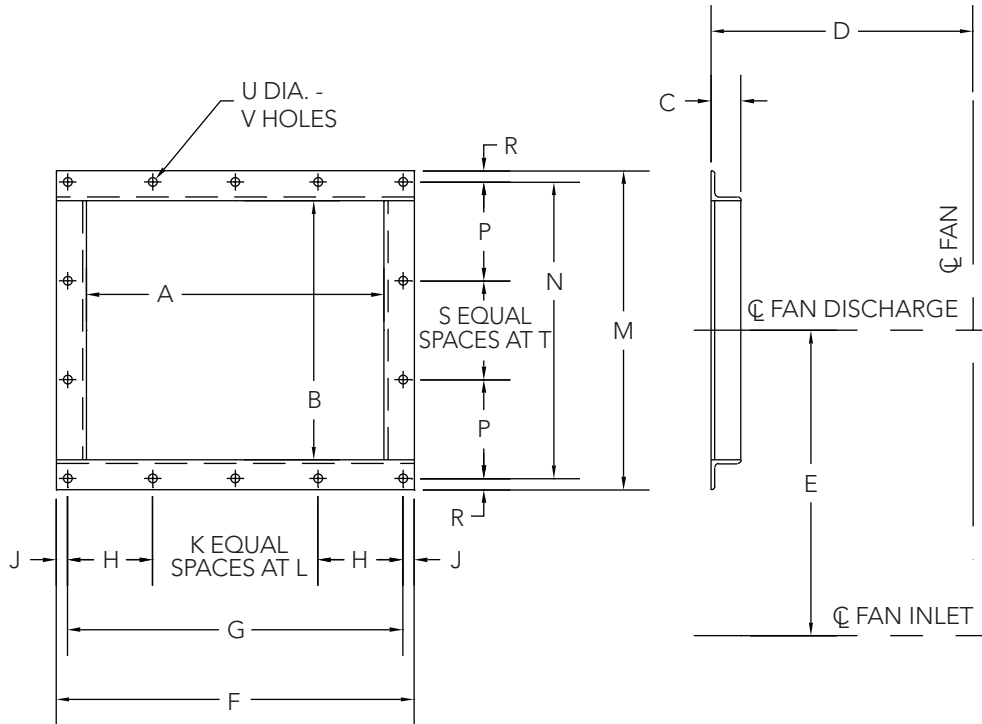

Outlet Flange

Fan Size	A	B	C	D	E	F	G	H	J	K	L	M	N	P	R	S	T	U	V	Fan Size
11	11 1/8	9 9/16	1 1/2	14 7/8	9 3/4	14 1/16	12 13/16	6 13/32	5/8	0	0	12 9/16	11 5/16	5 21/32	5/8	0	0	7/16	8	11
13	12 15/16	11 1/8	1 1/2	16 1/2	11 1/2	15 15/16	14 7/16	4 13/16	3/4	1	4 13/16	14 1/8	12 5/8	6 5/16	3/4	0	0	7/16	10	13
15	14 7/8	12 15/16	1 1/2	18 5/8	13 7/16	17 7/8	16 3/4	4 1/4	9/16	2	4 1/8	15 15/16	14 13/16	4 15/16	9/16	1	4 15/16	7/16	14	15
17	16 3/4	14 5/8	1 1/2	20 9/16	15 7/16	19 3/4	18 1/2	4 5/8	5/8	2	4 5/8	17 5/8	16 3/8	4 3/16	5/8	2	4	7/16	16	17
19	18 1/2	16 1/8	2	22 3/4	17 5/16	22 1/2	21 1/4	5 1/4	5/8	2	5 3/8	20 1/8	18 3/4	6 1/4	11/16	1	6 1/4	7/16	14	19
21	20 5/16	17 3/4	2	25 7/8	19 3/8	24 5/16	22 5/16	5 5/32	1	2	6	21 3/4	19 3/4	6 5/8	1	1	6 1/2	7/16	14	21
23	22 3/8	19 5/8	2	27 1/8	21 1/8	26 3/8	24 3/8	6 3/16	1	2	6	23 5/8	21 5/8	4 13/16	1	2	6	7/16	16	23
26	25 3/8	22 1/8	2	30 1/8	23 7/8	29 3/8	27 5/8	5 3/16	7/8	3	5 3/4	26 1/8	24 3/8	6	7/8	2	6 3/16	7/16	18	26
29	28 1/8	24 5/8	2	33 1/4	26 7/8	32 1/8	30 5/8	6 1/8	3/4	3	6 1/8	28 5/8	27 1/4	6 13/16	11/16	2	6 13/16	7/16	18	29
33	32	27 7/8	2	38 1/4	31 9/16	36	34	6 1/2	1	3	7	31 7/8	30	6	15/16	3	6	7/16	20	33
37	36	31 3/8	2	41 3/4	34 11/16	40	38	7	1	4	6	35 3/8	33 3/8	4 11/16	1	4	6	7/16	24	37
41	39 3/4	34 5/8	2 1/2	46 1/2	38 15/32	44 3/4	42 1/4	6 1/8	1 1/4	5	6	39 5/8	37 1/4	6 1/4	1 3/16	4	6 3/16	9/16	26	41

FAN WHEEL

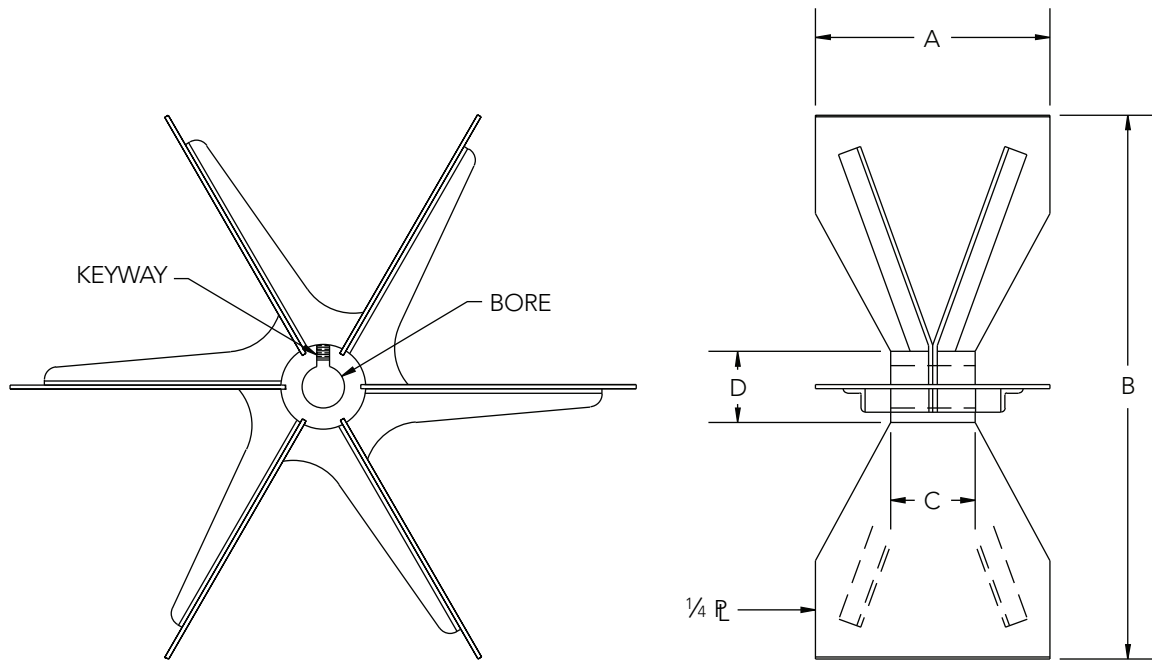

Fan Wheel							
Size No.	A	B	Bore	Shaft Length	Keyway	C	D
11	8	19 1/8	1 11/16	33	3/8 X 3/16	3 1/2	4
13	9 1/2	22 5/8	1 11/16	34 7/16	3/8 X 3/16	3 1/2	4
15	10 15/16	26 1/8	1 15/16	37 7/8	1/2 X 1/4	4	4
17	12 7/16	29 5/8	1 15/16	37 7/8	1/2 X 1/4	4	4
19	13 13/16	33	2 3/16	40	1/2 X 1/4	4 1/2	5
21	15 5/16	36 1/2	2 7/16	43	5/8 X 5/16	5	5
23	16 3/4	40	2 7/16	47 3/8	5/8 X 5/16	5	5
26	19	45 1/8	2 15/16	48 13/16	3/4 X 3/8	6	5 1/2
29	21 3/16	50 1/2	2 15/16	55 5/8	3/4 X 3/8	6	5 1/2
33	24	57	3 7/16	60	7/8 X 7/16	8	7
37	27 1/2	64 3/8	3 7/16	68	7/8 X 7/16	8	7
41	29 1/2	71	4 7/16	78	1 X 1/2	10	8

Note: All dimensions in inches.

DESIGNATIONS FOR ROTATION AND DISCHARGE OF CENTRIFUGAL FANS

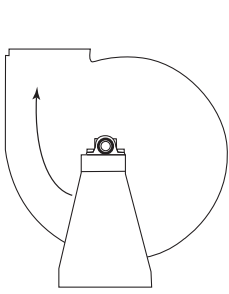

ClockWise
Up Blast
CW 360

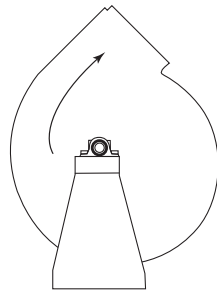

ClockWise
Top Angular Up
CW 45

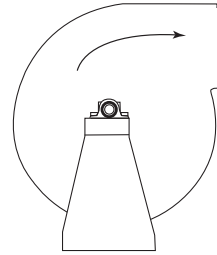

ClockWise
Top Horizontal
CW 90

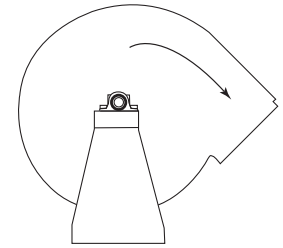

ClockWise
Top Angular Down
CW 135

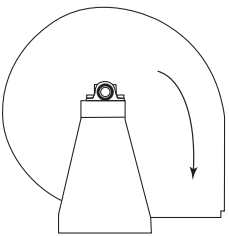

ClockWise
Down Blast
CW 180

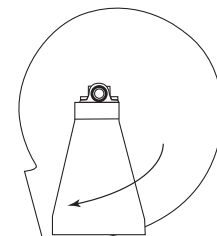

ClockWise Bottom
Angular Down
CW 255

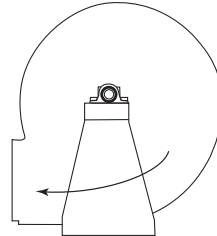

ClockWise Bottom
Horizontal
CW 270

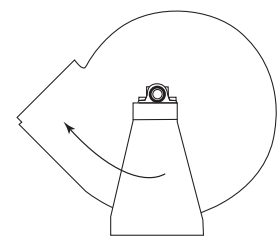

ClockWise Bottom
Angular Up
CW 315

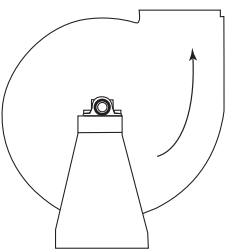

CounterClockWise
Up Blast
CCW 360

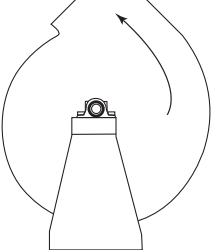

CounterClockWise
Top Angular Up
CCW 45

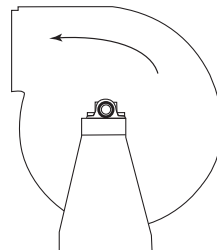

CounterClockWise
Top Horizontal
CCW 90

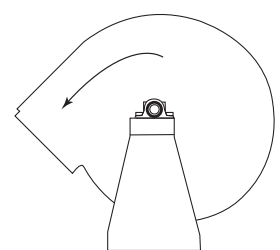

CounterClockWise
Top Angular Down
CCW 135

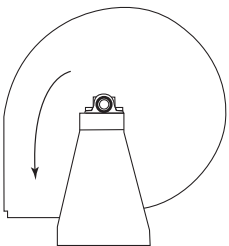

CounterClockWise
Down Blast
CCW 180

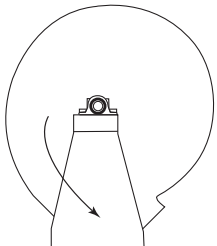

CounterClockWise
Bottom Angular Down
CCW 225

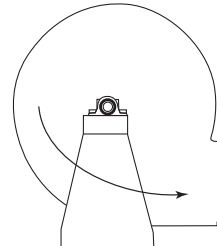

CounterClockWise
Bottom Horizontal
CCW 270

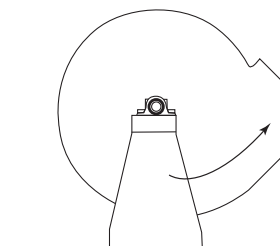

CounterClockWise
Bottom Angular Up
CCW 315

NOTES:

1. Direction of rotation is determined from drive side of fan.
2. On single inlet fans, drive side is always considered as the side opposite fan inlet.
3. Direction of discharge is determined in accordance with diagrams. Angle of discharge is referred to the vertical axis of fan and designated from such standard reference axis. Angle of discharge may be an intermediate angle as required.
4. For fan inverted for ceiling suspension or side wall mounting, direction of rotation and discharge is determined when fan is resting on floor.

Reprinted from AMCA
Publication 99-86, with the
express written permission from
the Air Movement and Control
Association International, Inc.
30 West University Drive
Arlington Heights, IL 60004-1893